



13, Central Drive, Rainford, WA11 8DE

£1,095 PCM

*David
Davies* *Collection*

13, Central Drive, Rainford, WA11 8DE

- EPC: D
- Council Tax Band: B
- End Town House
- Freehold
- Two Reception Rooms
- Gas Central Heating
- Modern Kitchen
- Three Bedrooms
- Village Location

David Davies Sales And Lettings Agent bring to the rental market this nicely presented three bedroomed end town house which is deceptively spacious in a sought after village location.

The accommodation briefly comprises:- entrance porch, spacious lounge, new modern kitchen, dining room, first floor galleried landing to three large bedrooms and shower room which completes this floor.

The property has UPVC double glazing, gas central heating, brick attached garage, front and rear gardens, and is within close proximity of the village centre and local schools.

EPC:D





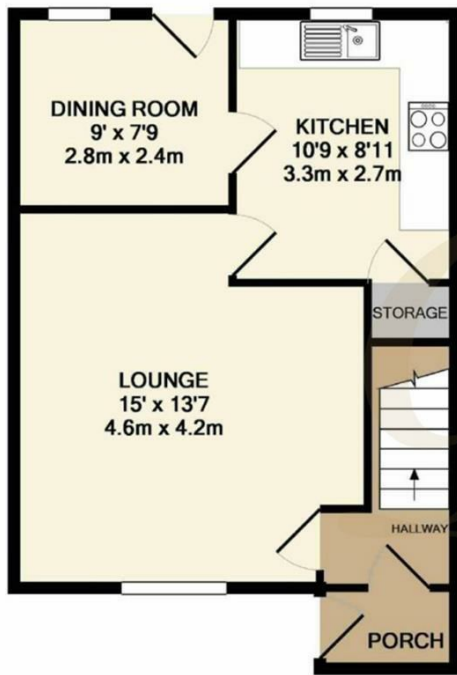

GROUND FLOOR
APPROX. FLOOR
AREA 418 SQ.FT.
(38.8 SQ.M.)

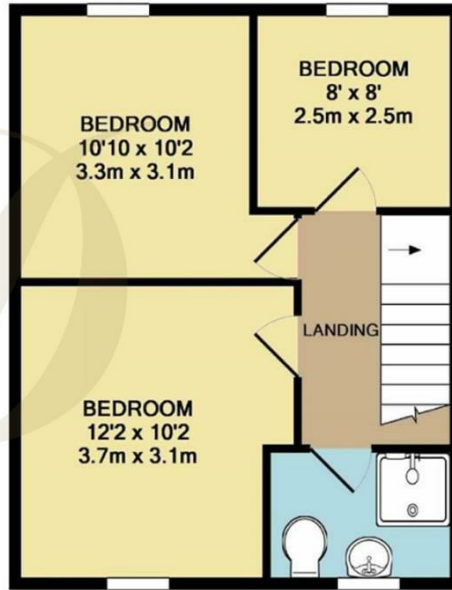

1ST FLOOR
APPROX. FLOOR
AREA 401 SQ.FT.
(37.2 SQ.M.)



Our family owned Independent Estate Agency was established in 1981 and provides a **refreshingly professional service** combining traditional values with a modern approach.

David Paul David

